

Great Room Addition at Heritage Manor East

PROJECT #2.2314.48

Primary Service: Architecture
Type: Healthcare
Owner/Client: Christian Health Care Center
Location: Wyckoff, New Jersey
Cost: \$8,000,000
Square Footage: 6,300 sf
Completion Date: August 2008
Contact: Mr. Hank Schuurman
V.P. of Facilities Development
201.848.5842



Great Room Interior



Activity Room

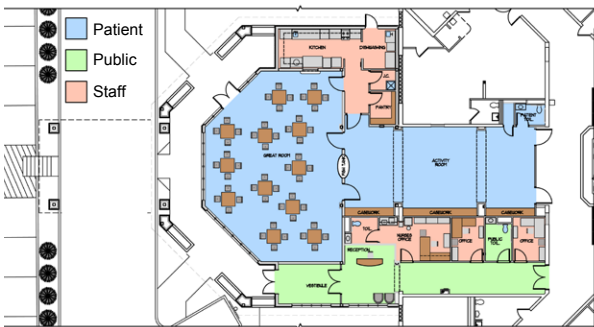

Key Floor Plan

Project Scope:

LAN is the Architect and Engineer of Record for the great room addition at Heritage Manor East. LAN has worked with the staff at Christian Health Care Center to ensure the functional arrangement of rooms will accommodate the staff and residents. The great room will incorporate a large, open dining space with clerestory windows and a "rocking chair" front porch so residents can enjoy the fresh air and views within a semi-enclosed area. The aesthetic incorporates cultured stone and wood clapboard siding to diminish the institutional character of the building.

LAN submitted drawings to the Department of Community Affairs and designed the addition in full compliance with all governing building codes. This project was completed in August 2008.

Services Performed:

- Architectural Design & Documentation
- Civil, Structural, Mechanical, Electrical & Sprinkler Engineering
- Construction Administration & Observation

Program Highlights:

- Great Room
- Dining Area
- Entry Canopy



Built-in Fish Tank

LAN

LAN ASSOCIATES

ENGINEERING ■ PLANNING ■ ARCHITECTURE ■ SURVEYING

Since 1965